

## **CFS-21-H - INSTALLATION GUIDE**

---

Information to consider before installing your TERRA Food-Tech<sup>®</sup> equipment.

### INDEX

Electrical connection .....	Page 2
Connections Information .....	Page 2
Included hoses .....	Page 3
Automatic water supply .....	Page 3
Drain .....	Page 3
Dimensions to take in consideration for the installation of the equipment .....	Page 4
Conditions (temperature, humidity, altitude) .....	Page 4



# COMPACT AUTOCLAVES FOR CANNED FOOD

BENCHTOP MODEL

## ELECTRICAL CONNECTION

MODEL	FREQUENCY	CURRENT	VOLTAGE	CONNECTION*
CFS-21-H	50/60 Hz	2000 W	230 (1P+N+E) V	16 A ①

\* Standard plugs. Consult for other plugs.



## CONNECTIONS INFORMATION

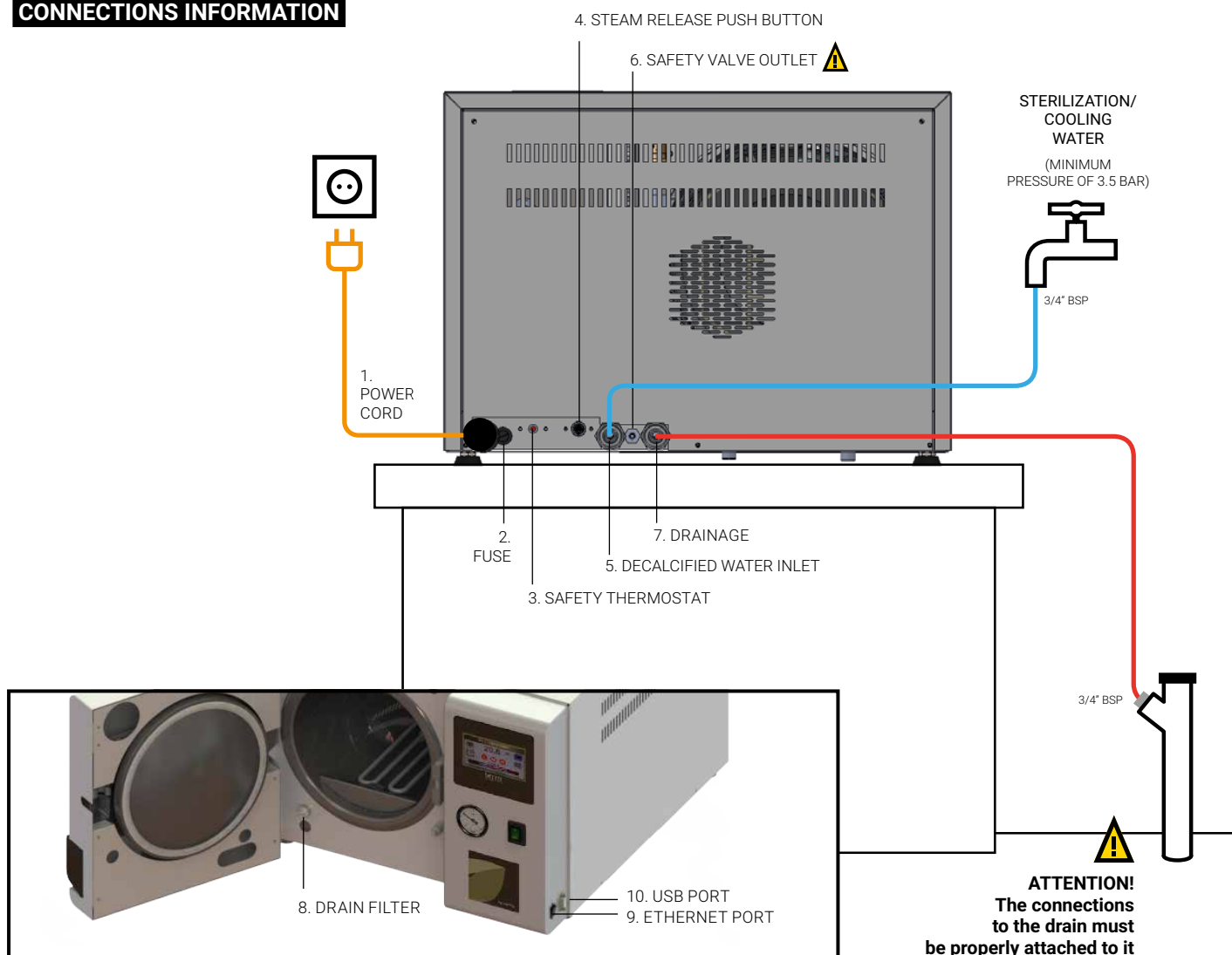

### INCLUDED HOSES

2 hoses 2 meters long (3/4" BSP)

For:

- 5. DECALCIFIED WATER INLET
- 7. DRAINAGE



### DRAIN

You will need a drain near of the equipment for:

- 7. DRAINAGE

#### NOTE:

The equipment incorporates a system that mixes the cooling water with the hot water resulting from the sterilization. In this way, the drain water temperature is reduced to 60 or 70 °C depending on the incoming cooling water temperature.

### AUTOMATIC WATER SUPPLY

- 5. DECALCIFIED WATER INLET (FOR STERILIZATION / COOLING)

The water used is suggested to be **soft** or **decalcified** to prevent from depositing waste inside the deposit. 3/4" BSP thread connection tap with a minimum network pressure of 3.5 bar.



3/4" BSP  
DECALCIFIED TAP WATER

# COMPACT AUTOCLAVES FOR CANNED FOOD

BENCHTOP MODEL



## DIMENSIONS TO TAKE IN CONSIDERATION FOR THE INSTALLATION OF THE EQUIPMENT

Due to safety reasons, the distance between the instrument and the wall has to be no less than 20 cm. A distance of 10 cm has to be left to both sides of the machine.

MODEL	L LENGTH (with closed lid)	L1 LENGTH (with open lid)	D DEPTH	D1 DEPTH (with open lid)	H HEIGHT	H D DRAINAGE
CFS-21-H	590 mm	730 mm	665 mm	1025 mm	425 mm	10 mm

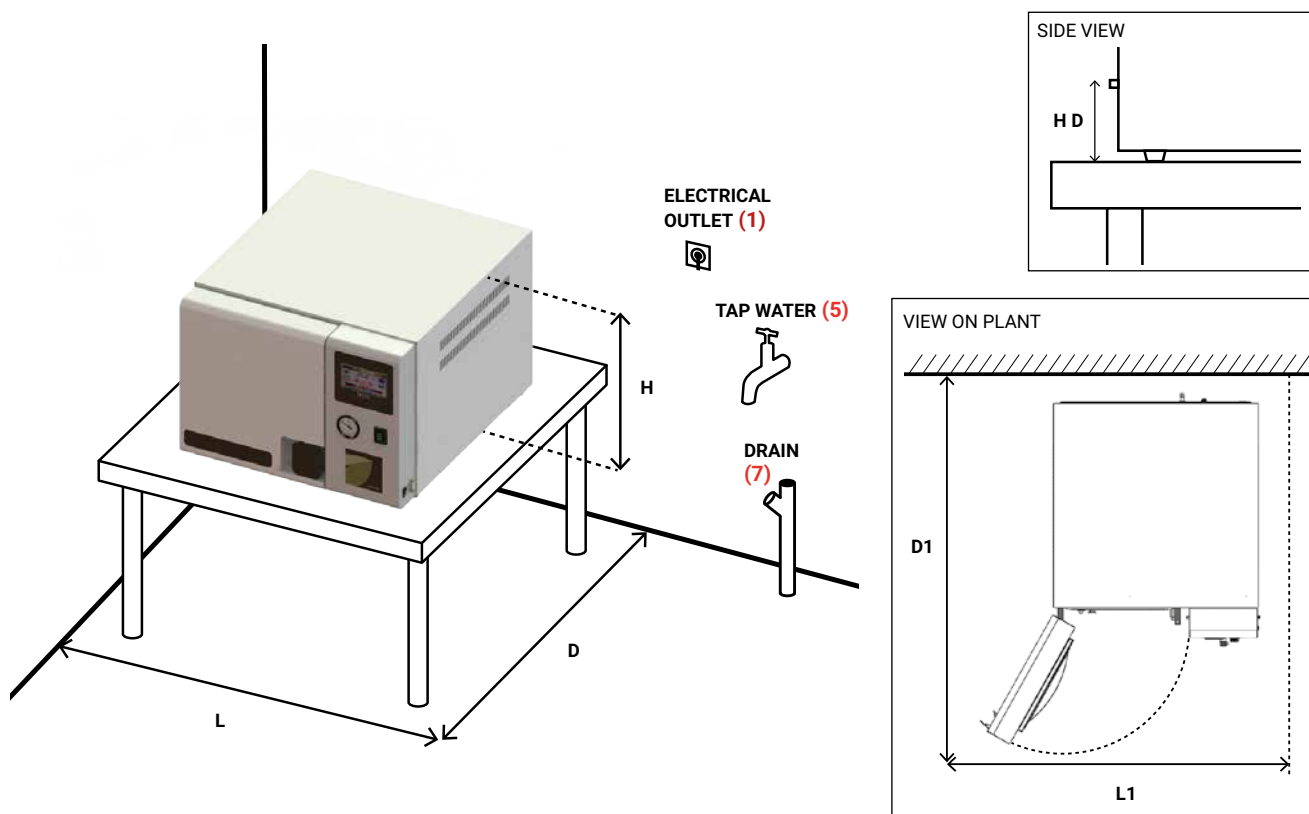

**WARNING:**  
Observe distance!

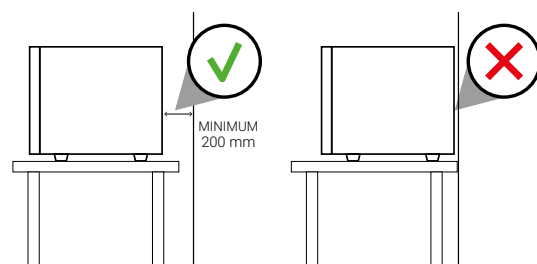

## CONDITIONS

This equipment is ready to operate under the following maximum conditions:

- Room temperature: 30°C
- Humidity: 75%
- Altitude: 2000 meters



Avinguda del Vallès, 322  
Pol. Ind. "Els Bellots"  
08227 Terrassa (Barcelona), Spain

Tel. +34 937 830 720  
hello@terrafoodtech.com  
www.terrafoodtech.com

TERRA Food-Tech® is a registered trademark of R.Espinar S.L.



R. ESPINAR, S.L.

REV 10.2020